

VILLAGE ESTATES

93 Main Road, Sidcup, Kent DA14 6ND

Tel: 0208 302 1002

www.village-estates.com

Email: sidcup@village-estates.com



LOFT ROOM

CHAIN FREE

TWO CAR DRIVEWAY

IMMACULATELY PRESENTED

KITCHEN DINER

CLOSE TO NEW ELTHAM TRAIN ST



11 Woodchurch Close
Sidcup, DA14 6QH

Guide Price £325,000-£350,000

*** GUIDE PRICE £325,000-£350,000 * A superb TWO BEDROOM terraced house with a two car DRIVEWAY, located within walking distance to NEW ELTHAM TRAIN STATION (zone 4). This very well presented property also benefits from a LOFT ROOM and is offered with NO FORWARD CHAIN!**

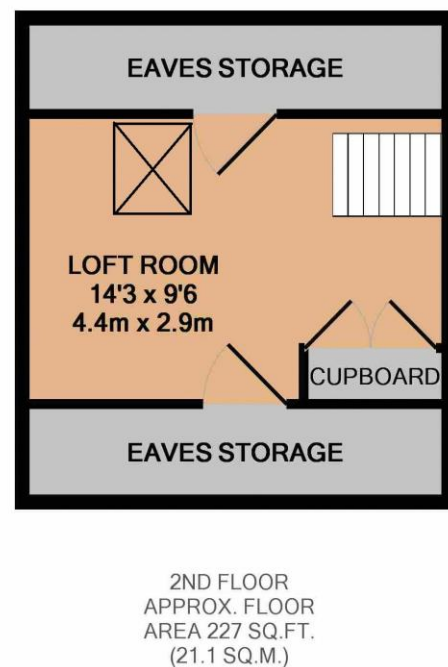
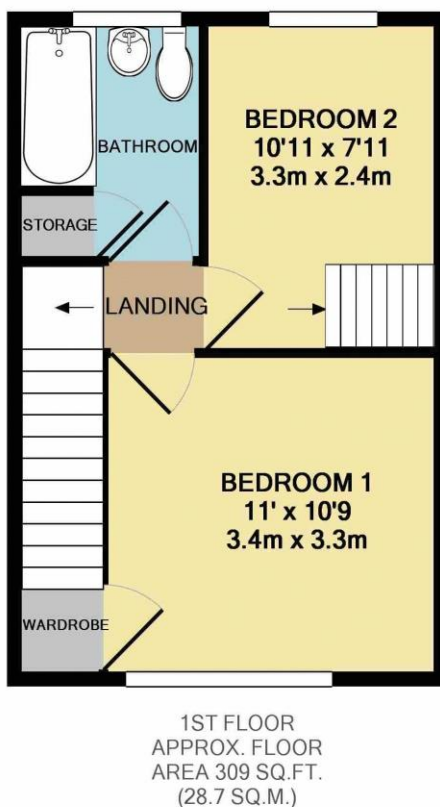
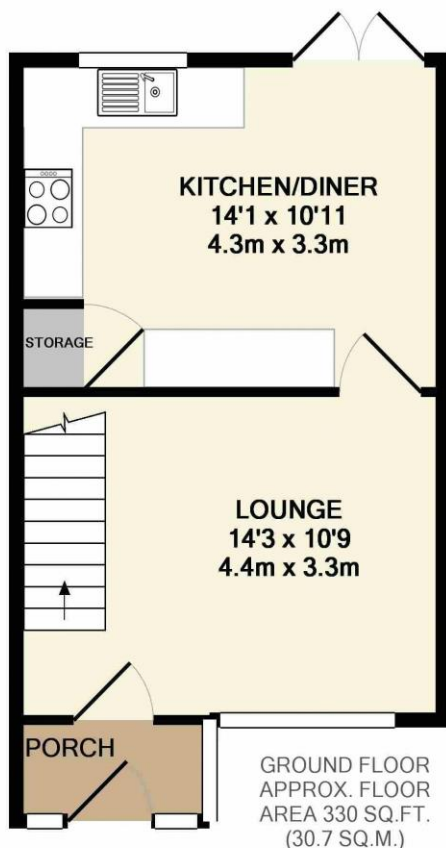

TOTAL APPROX. FLOOR AREA 866 SQ.FT. (80.5 SQ.M.)

Whilst every attempt has been made to ensure the accuracy of the floor plan contained here, measurements of doors, windows, rooms and any other items are approximate and no responsibility is taken for any error, omission, or mis-statement. This plan is for illustrative purposes only and should be used as such by any prospective purchaser. The services, systems and appliances shown have not been tested and no guarantee as to their operability or efficiency can be given

Made with Metropix ©2019

CURRENT ENERGY EFFICIENCY RATING 'D'

MONEY LAUNDERING REGULATIONS 2003

Intending purchasers will be asked to produce identification and proof of financial status when an offer is received. We would ask for your co-operation in order that there will be no delay in agreeing the sale.

CONSUMER PROTECTION FROM UNFAIR TRADING REGULATIONS 2008

Please note that any services, heating system or appliances have not been tested, and no warranty can be given or implied as to their working order. You are advised to obtain verification from your solicitor or surveyor. References to the tenure of a property are based on information supplied by the seller. We have not had sight of the title documents and a buyer is advised to obtain verification from their solicitor. Items shown in photographs are not included unless specifically mentioned within the sales particulars, but may be available by separate negotiation. Whilst every attempt has been made to ensure the accuracy of the floor plan contained here, measurements of doors, windows, rooms and any other items are approximate and no responsibility is taken for any error, omission, or mis-statement. We advise you to book an appointment to view before embarking on any journey to see a property, and check its availability. The accuracy of these details are not guaranteed and they do not form part of the contract.